

**S030**

# Electrical Current Transmitter

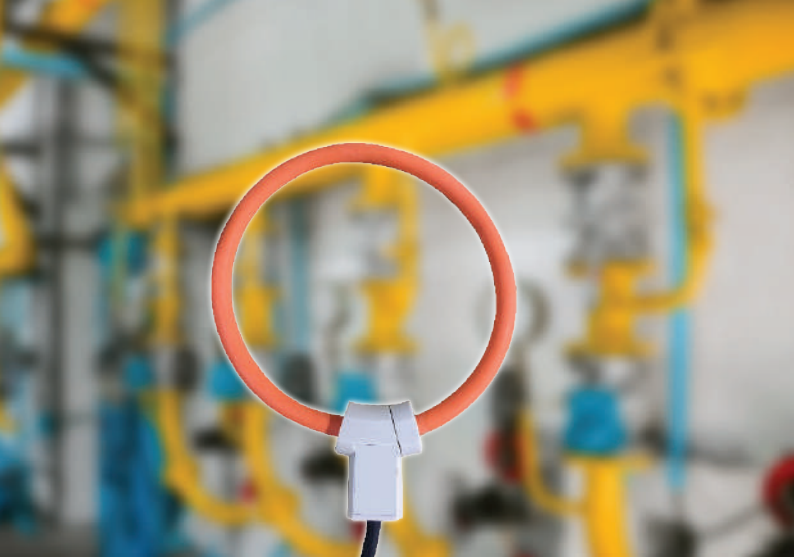



## Benefits

- ✓ Easy installation
- ✓ Wide measuring range
- ✓ Accurate current sensing
- ✓ 4 ... 20 mA output signal
- ✓ IP67 casing provides robust protection in the industrial environment

## Accurate current measurement

SUTO current sensor is an AC RMS current sensor composed of a flexible active part (Rogowski coil model) connected to a compact digital converter, capable of measuring the current carried on a power conductor up to a value of 3000 A AC.



The digital converter supplies an output of 4 ... 20 mA DC in linear proportion to the measured current.

## Current Transmitter Application

- Current sensing at compressors for load / unload analysis
- Current sensing for power / energy measurement
- Evaluation of machine operation hours

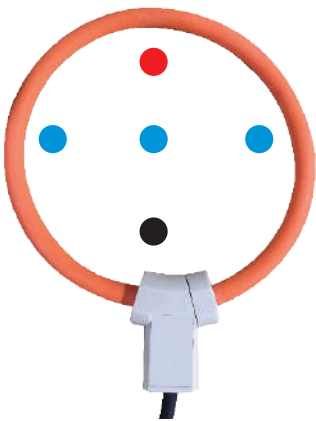
## Position Sensitivity



Conductor Position	Typical Error(%)
	< 0.5 %
	< 0.8 %
	< 1 %

## Single Phase Power Measurements

By measuring the current of a symmetric power consumer on one phase, compressed air experts are able to calculate the power consumption of the compressors without the need of measuring voltage additionally.

This offers an analysis of the compressor and allows to judge the efficiency of the system.

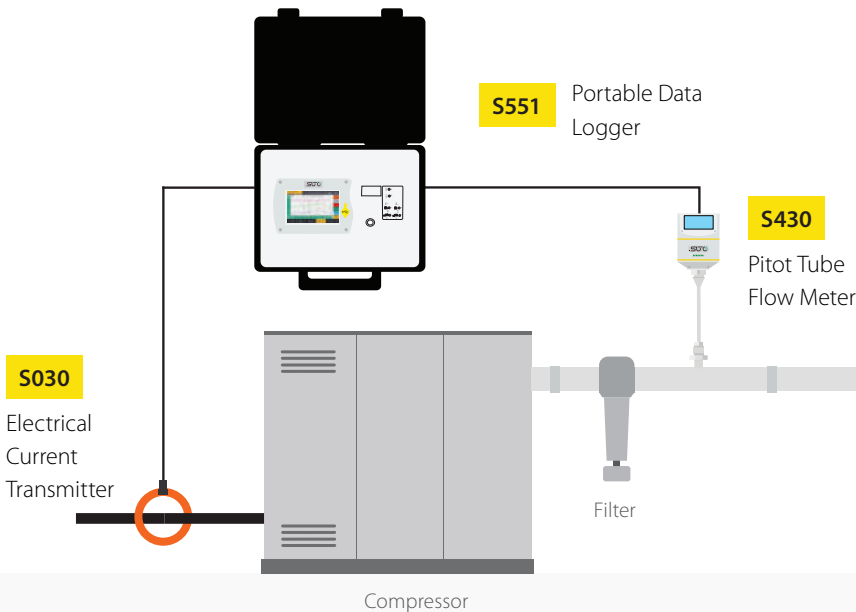

## Technical Data

### Measurement

#### Current

Accuracy	0,5 % of reading + 0,2 % of range
Measuring range	10 ... 1000 A(AC) / 30... 3000 A(AC)

### Signal / Interface & Supply

#### Analog output

Signal	4 ... 20 mA 3-wire
Scaling	4 mA = 0A AC, 20 mA = 1000A / 3000 A AC
Load	Max. 300 Ohm

#### Supply

Voltage supply	10 – 32 VDC
Current consumption	Max. 30 mA

#### Data interface

Connection	Open wire ends / ODU connector
------------	--------------------------------

### General data

#### Miscellaneous

Protection class	IP67
------------------	------

Approvals	CE
-----------	----

#### Operating conditions

Ambient temperature	0 ... +80 °C
---------------------	--------------

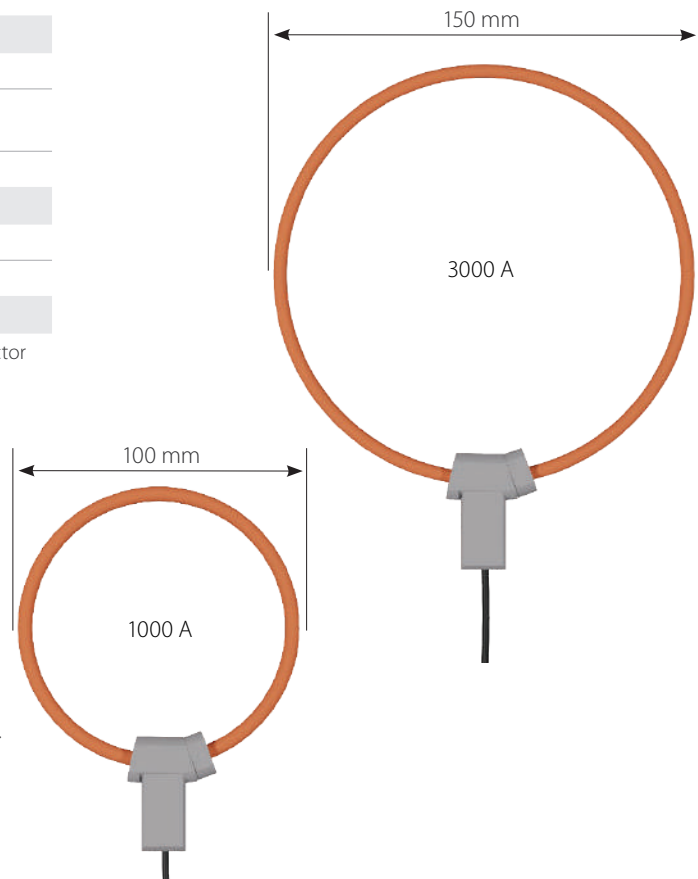

#### Note:

This current transducer is intended for stand-alone applications. The signal is a 4 ... 20 mA output which cannot be connected to the S110 Power and Energy Meter.

If you are looking for current transducers for the S110, please refer to the S110 order sheet.

## Ordering

Please use the following table to assist in placing your order with our sales staff.

### S030 Electrical Current Transmitter

Order No.	Description
S554 0155	Electrical Current Transmitter, 10 ... 1000 A, 100 mm diameter, 4 ... 20 mA analog output, 2 m cable open ends
S554 0156	Electrical Current Transmitter, 10 ... 1000 A, 100 mm diameter, 4 ... 20 mA analog output, 2 m cable incl. connector to S551-P6
S554 0157	Electrical Current Transmitter, 30 ... 3000 A, 150 mm diameter, 4 ... 20 mA analog output, 2 m cable incl. connector to S551-P6
S554 0158	Electrical Current Transmitter, 30 ... 3000 A, 150 mm diameter, 4 ... 20 mA analog output, 2 m cable open ends



[www.augustindonesiajaya.com](http://www.augustindonesiajaya.com)



[sales@augustindonesiajaya.com](mailto:sales@augustindonesiajaya.com)